

QUANTUM[®] SSC 3

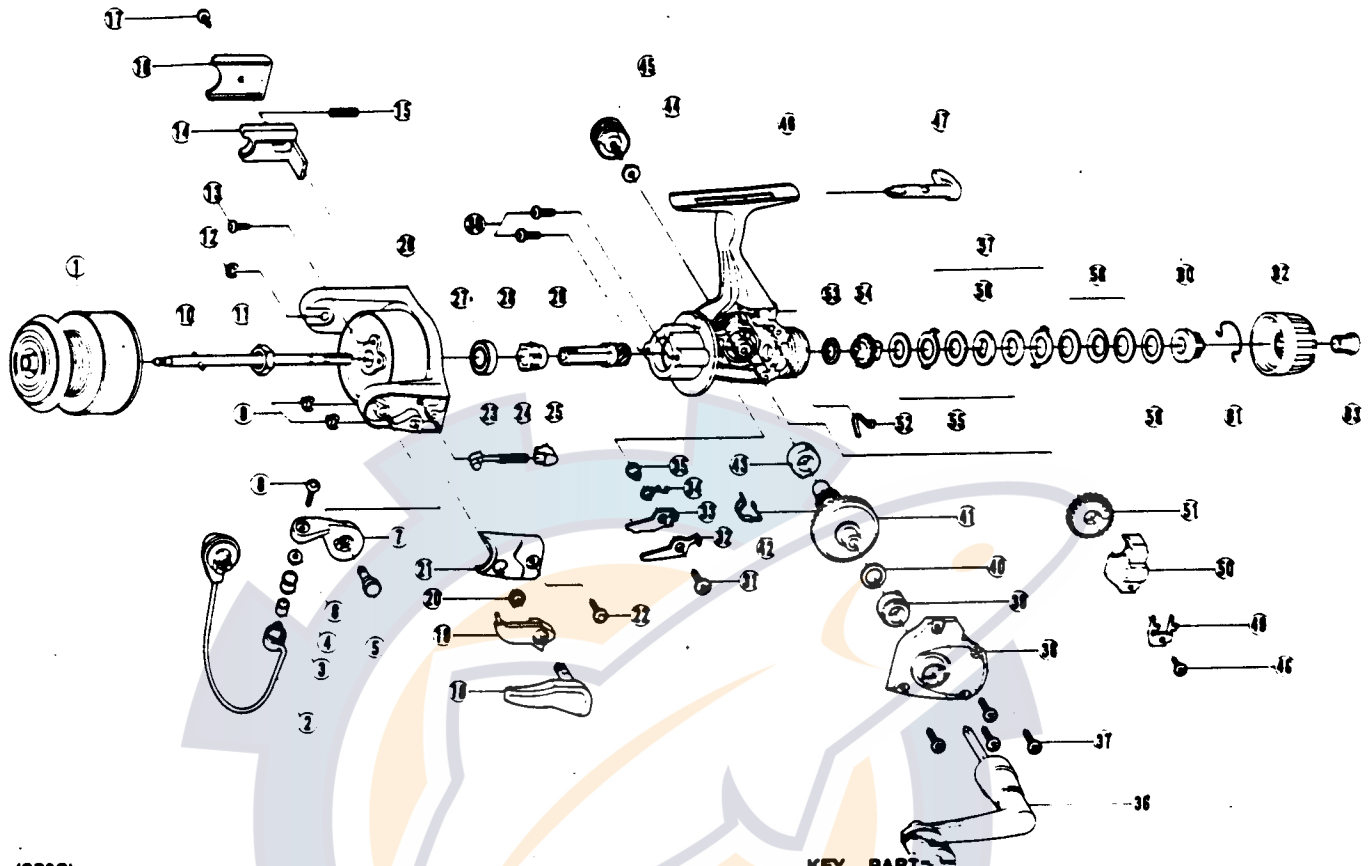

(SS3C)

KEY NO.	PART NO.	DESCRIPTION	PRICE	KEY NO.	PART NO.	DESCRIPTION	PRICE
1	JU321-16	SPOOL ASSEMBLY	8.50	33	JU074-01	ANTIREVERSE PAWL "B" ON	.95
2	GU347-12	BAIL ASSEMBLY	5.50	34	JU061-01	ANTIREVERSE PAWL SPRING	1.00
3	MT016-02	LINE ROLLER BUSHING	.75	35	GU091-02	ANTIREVERSE PAWL POST	.70
4	MT004-01	LINE ROLLER	1.20	36	GU318-21	HANDLE ASSEMBLY	5.15
5	GU051-08	ARM LEVER PIN	1.00	37	JU057-02	BODY COVER SCREW	.40
6	GU105-07	LINE ROLLER WASHER	.15	38	JU023-05	BODY COVER	2.60
7	JU007-02	ARM LEVER	1.65	39	JU027-01	GEAR SHAFT BUSHING	1.55
8	KQ108-03	LINE SLIDER SCREW	.85	40	GU105-13	ADJUSTMENT WASHER	.62
9	KQ034-01	E-CLIP	.15	41	JU012-01B	DRIVER GEAR	3.35
10	JU315-01	MAIN SHAFT ASSEMBLY	1.75	42	JU088-01	SILENT CAM	1.10
11	GU006-02	ROTOR NUT	.80	43	JU027-01	GEAR SHAFT BUSHING	1.55
12	KQ034-01	E-CLIP	.15	44	GU105-01	HANDLE SCREW WASHER	.10
13	GU077-04	ROTOR NUT LOCK SCREW	.15	45	GU073-05	HANDLE SCREW	1.10
14	JU019-01	KICK LEVER	1.00	46	JU001-05	BODY	10.05
15	KQ049-01	KICK LEVER SPRING	.25	47	GU090-03	ANTIREVERSE LEVER	2.30
16	JU046-02	KICK LEVER COVER	.80	48	JU100-01	OSCILLATOR RETAINER SCREW	.25
17	GU077-03	KICK LEVER COVER SCREW	.60	49	JU078-01	OSCILLATOR SLIDE RETAINER	.30
18	GU115-04	TRIGGER ASSEMBLY	3.50	50	JU025-01	OSCILLATOR SLIDER	1.75
19	GU097-04	TRIGGER LINK ASSEMBLY	1.65	51	JU053-01	OSCILLATOR GEAR	1.75
20	NL096-01	TRIGGER SPRING	.80	52	JU089-01	ANTIREVERSE LEVER SPRING	.50
21	GU087-02	ARM LEVER SPRING COVER	.65	53	GU105-17	DRAG FRICTION WASHER "A"	.77
22	GU077-03	ARM LEVER COVER SCREW	.60	54	JU075-01	DRAG CLICK GEAR	1.25
23	QL031-01	ARM LEVER SPRING PIN	.75	55	GU105-18	DRAG DISC	.88
24	KQ049-02A	ARM LEVER SPRING	.85	56	JU080-01	DRAG WASHER "D"	1.00
25	QL020-01	ARM LEVER SPRING HOLDER	.30	57	JU081-01	DRAG WASHER KEYED	1.00
26	JU009-05	ROTOR	3.70	58	JU043-01	DRAG SPRING	1.30
27	AQ028-06	BALL BEARING	6.10	59	GU105-19	DRAG WASHER	.93
28	JU060-01	ANTIREVERSE RATCHET	2.35	60	JU066-01	DRAG NUT	1.25
29	JU011-01	PINION GEAR	2.30	61	JU083-01	DRAG CLICK SPRING	1.85
30	JU077-01	BEARING SCREW	.60	62	JU032-03	DRAG KNOB	1.50
31	GU077-05	ANTIREVERSE PAWL SCREW	.15	63	JU101-01	DRAG KNOB SCREW	1.25
32	JU083-01	ANTIREVERSE PAWL "A" CNTR	.95				

Prices subject to change without notice. Prices do not include postage and handling.

PLEASE ORDER BY PART NUMBER

Rev. 6/94

Zebco Division Brunswick Corporation, Box 270, Tulsa, OK 74101 USA 918-836-5581

